

breezeYachting swiss



# Palmer Johnson PJ150 'EQUITY'

€9'950'000 incl. VAT | 45.72m | 2008/2019

*Welcome aboard EQUITY, a magnificent 45.72-meter (150-foot) Palmer Johnson PJ150, representing a perfect fusion of high performance and distinctive superyacht design.*

Conceived by the iconic design studio Nuvolari & Lenard, this aluminum-hulled sport yacht commands attention with her sleek lines and impressive capabilities. Powered by twin MTU 16V4000M90 engines delivering a total of 7,298 HP, EQUITY delivers an exhilarating top speed of 28 knots and a comfortable cruising speed of 22 knots, offering swift passage between your favorite destinations.

Step into a space of refined comfort and volume. With a substantial beam of 8.40 meters, EQUITY offers expansive decks and living areas far exceeding many yachts in her class. To ensure ultimate guest enjoyment, she is equipped with ABT-Trac Zero speed stabilizers, guaranteeing maximum stability whether cruising at speed or relaxing peacefully at anchor. Furthermore, as a VAT-paid vessel, she offers a simplified and immediate cruising solution.



# SPECIFICATIONS

<b>Builder:</b>	Palmer Johnson
<b>Model:</b>	PJ150
<b>Year Built:</b>	2008
<b>Refit Year:</b>	2019
<b>Hull/Superstructure:</b>	Aluminum
<b>Deck material:</b>	Teak
<b>Flag:</b>	Portugal
<b>Class:</b>	Bureau Veritas
<b>Interior Designer:</b>	Nuvolari & Lenard
<b>Exterior Designer:</b>	Nuvolari & Lenard
<b>Length overall:</b>	45.72 m
<b>Beam:</b>	8.40 m
<b>Draft:</b>	1.90 m
<b>Gross tonnage:</b>	395 GT
<b>Displacement:</b>	200 T
<b>Guests:</b>	12
<b>Staterooms:</b>	5
<b>Cabins configuration:</b>	2 x Double, 1 x Master, 2 x Twin
<b>Crew:</b>	8
<b>Crew Cabins:</b>	5
<b>Crew Cabins configuration:</b>	1 x Captain, 1 x Engineer, 3 x Crew
<b>Engines:</b>	2 x MTU 16V4000M90
<b>Engine Hours:</b>	3500 hrs
<b>Total Power:</b>	7,298 HP
<b>Range:</b>	850Nm @ 17kn
<b>Consumption:</b>	800l/h @17kn
<b>Generators:</b>	2 x 70 kW (94 Hp) Kilopak
<b>Generator hours:</b>	port: 8,558hrs; stbd: 6,357 hrs
<b>Economy Speed:</b>	17 knots
<b>Cruising Speed:</b>	22 knots
<b>Maximum Speed:</b>	28 knots
<b>Stabilizers:</b>	ABT-Trac Zero speed
<b>Fuel tank:</b>	40,000 l
<b>Fresh water tank:</b>	5,700 l
<b>Black and gray water tanks:</b>	1726 l



# KEY POINTS

- Exceptional Performance: Max speed of 28 knots and a cruising speed of 22 knots, powered by twin 3,649 Hp MTU engines.
- Iconic Design: A 45.72m Palmer Johnson PJ150 featuring sophisticated exterior and interior styling by Nuvolari & Lenard.
- Zero Speed Stabilization: Equipped with ABT-Trac Zero speed stabilizers for maximum comfort at anchor and while underway.
- Luxury Accommodation: Generous layout accommodating 10-12 guests in 5 luxurious cabins.
- Ready Condition: Recently refitted in 2018 with a full paint job, ensuring her excellent aesthetic and structural condition.









breezeYachting.swiss

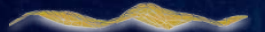

























breezeYachting swiss











breezeYachting swiss





breezeYachting swiss









breezeYachting swiss













# EQUIPMENT

## MECHANICAL EQUIPMENT

- Gear Box: ZF
  - Steering: Electrohydraulic, fly by wire at helm
  - Water Maker: 2 X FCI Watermakers 400lt/h
  - Fuel Filters: Separ fuel filters with gauge, water sensor, priming pump
  - Air Conditioning: Reverse Cycle air conditioning system, Fresh makeup air system
  - Bow Thruster: Proportional control
  - Boiler: 1 x Electric heating elements
- 

## DECK EQUIPMENT

- Anchor Windlass: 2 X ANCHOR WINDLASSES Maxwell
  - Aft Warping Capstans: 2 X AFT WARPING CAPSTANS Maxwell
  - Anchors: 2 X ANCHORS
  - Anchor Chains: 2 X ANCHOR CHAINS
  - Passerelle: STERN PASSERELLE Besenzoni
  - Swimming Platform: SWIMMING PLATFORM
- 

## NAVIGATION AND COMMUNICATION

- VHF: 2 x VHF radios, 2 x Portable GMDSS radios with charger, 7 x Portable radios, and 2 x DSC VHF controllers.
- SATCOM: 1 x Inmarsat C.
- Radar: 2 x X-band radars.
- GPS/AIS: 1 x DGPS with AIS system.
- Autopilot: 1 x Auto pilot.
- Compasses: 1 x Gyrocompass and a Furuno magnetic compass.
- Instruments: Instrument package with wind, speed, and depth, and a depth sounder.
- Plotter: 1 x Chart plotting system.
- Safety: 2 x EPIRB and 1 x SART.
- Other: NAVTEX.



# EQUIPMENT

## GALLEY & LAUNDRY

- Cooking Equipment: Cooktop: Miele four burner induction type
  - Microwave: Miele Microwave oven
  - Extractor Fan: Miele Range hood
  - Dishwasher: Miele Dishwasher
  - Refrigerator: Subzero Model 700TR
  - Freezer: Subzero Model 700TC
  - Washing Machine: 2 x Stacked clothes washer units
  - Dryer: 2 x Stacked clothes dryer units
- 

## AUDIO VISUAL EQUIPMENT

- Audio Equipment: Bose loudspeaker system throughout all cabins and exterior, and a CD player connected to the Zeuss Navi system.
  - Video Equipment: Television with a mast-mounted antenna.
- 

## ELECTRICAL SYSTEMS

- Shore Power: 1 x Glendenning CMS cable reel aft, 100ft of shore power cable
- Electricity Output: 50Hz system with three phase and single phase voltages
- Converter: Converter, compatible EU & USA (110,220)
- Main Engine Starting Batteries: 2 x 24V starting battery banks for the main engines
- Generator Starting Batteries: 2 x 24V starting battery banks for generators



# EQUIPMENT

## SAFETY & FIRE PROTECTION

### Fire Fighting Systems:

- NOVEC Engine room fire system.
- Fog/mist fire system for accommodations.
- Portable fire extinguishers and a portable fire pump.
- 2 x Fire suits, each with SCBA, a Fire axe, and a Fire blanket.

### Safety & Alarms:

- ALARM SYSTEM, which monitors fire, bilge, and tank capacities.
- Adult and child life jackets, both with light and whistle.
- 2 x Liferings with light and smoke, 2 x Liferings with buoyant line, and 1 x Line throwing device.
- 1 x Set of six rocket flares.
- 2 x Portable GMDSS radios.
- 2 x EPIRB and 1 x SART.

### Security & Monitoring:

- CCTV system with 4 CAMERAS.
  - Monitors are located in the pilothouse, crew lounge, engine room, Captain Cabin, and Engineer Cabin.
- 

## TENDERS & TOYS

- Tenders: 1 x Williams diesel Jet 445
- Water Toys: 1 x Jet ski Sea-doo, 2 x Seabob F5
- Recreation: 1 x Wakeboard, 1 x Water Ski



# LAYOUTS

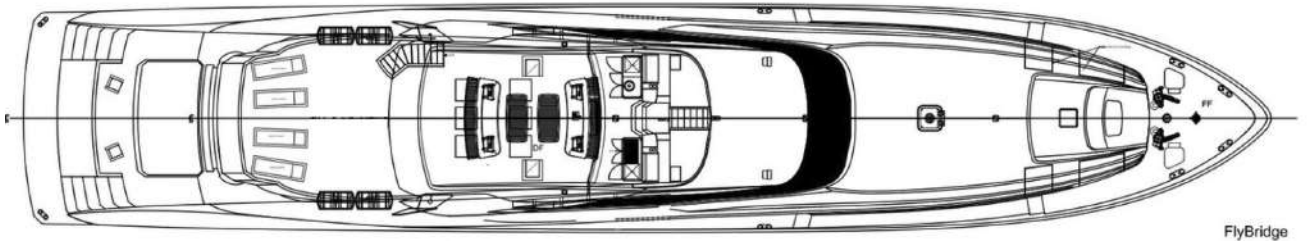

FlyBridge

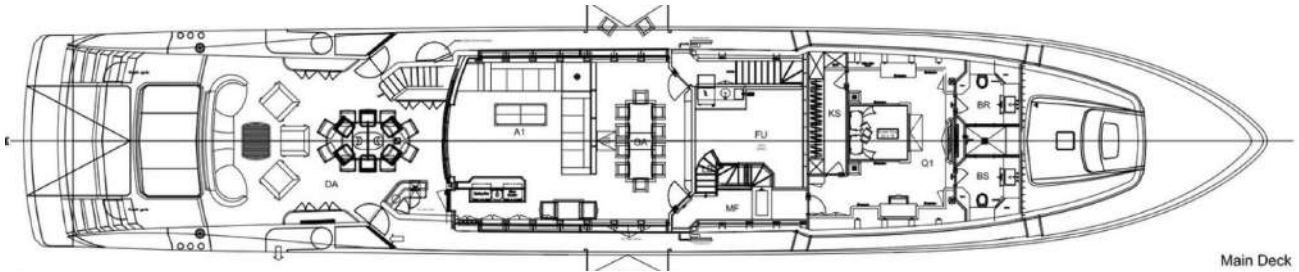

Main Deck

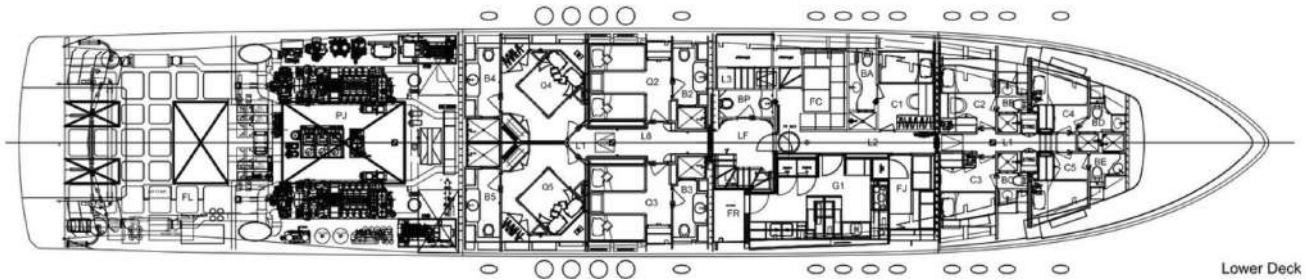

Lower Deck



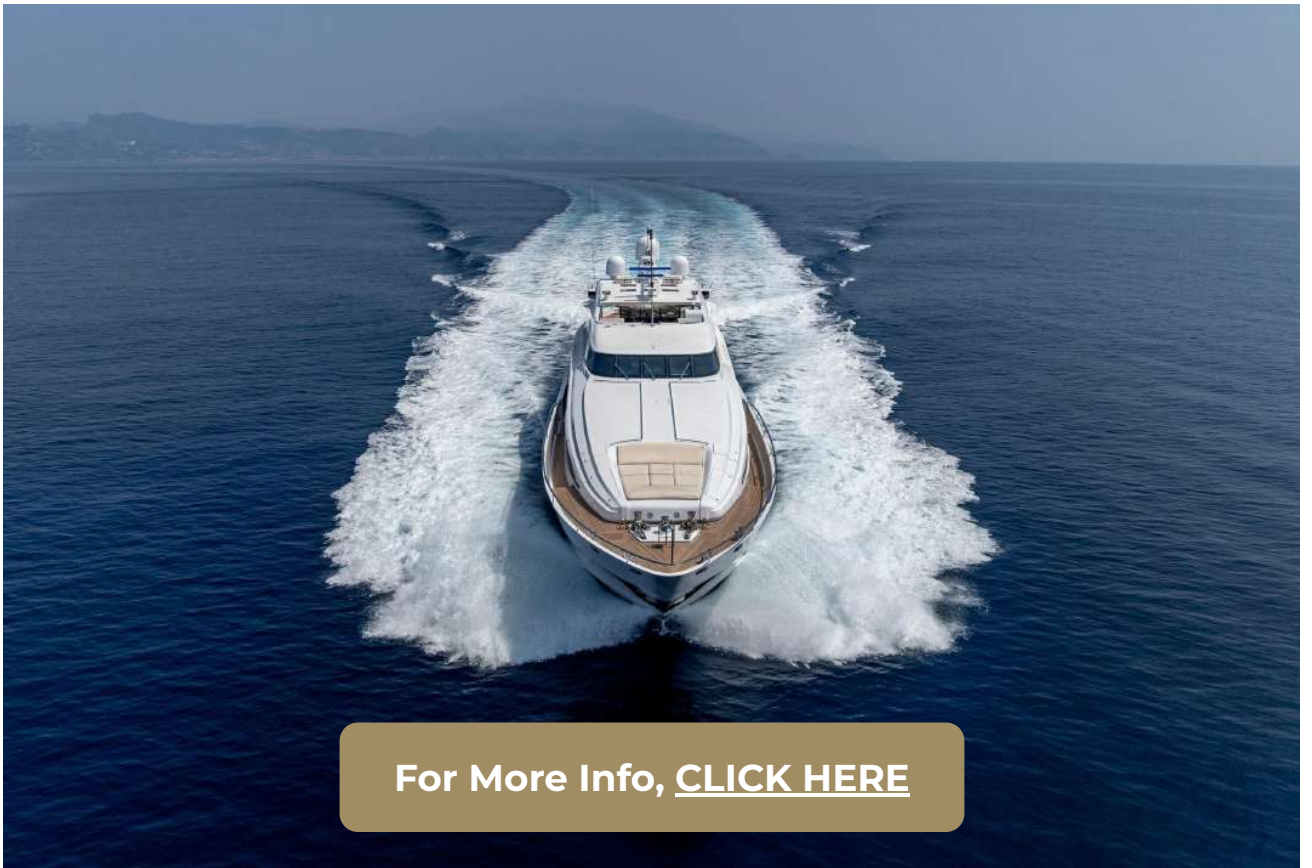

For More Info, [CLICK HERE](#)



breezeYachting swiss

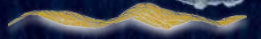



**CASSIDY WOODS**

Yacht Advisor Malta

 WHATSAPP ME

m. +35 69 933 8880

[cass@breezeyachting.swiss](mailto:cass@breezeyachting.swiss)

# breezeYachting.swiss

WE SPEAK YACHTING. LET'S TALK.

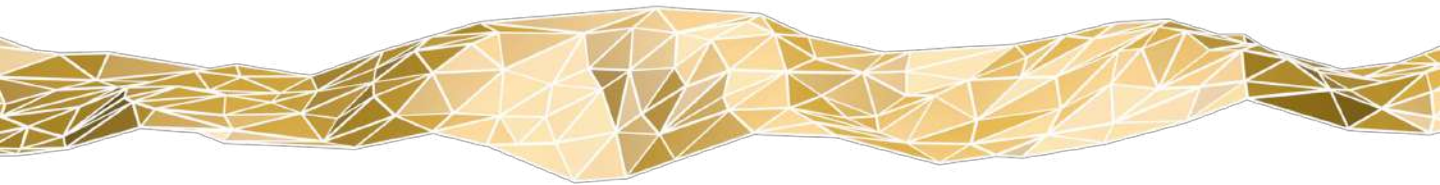

Switzerland ● Malta ● Spain ● Monaco ● St. Tropez

[www.breezeyachting.swiss](http://www.breezeyachting.swiss)

DISCLAIMER

The company offers the details of this vessel in good faith but cannot guarantee or warrant the accuracy of this information nor warrant the condition of the vessel. A buyer should instruct his agents, or his surveyors, to investigate such details as the buyer desires validated.

This vessel is offered subject to prior sale, price change or withdrawal without notice.