

breezeYachting.swiss



SANLORENZO SX76

'LOVE IS IN THE AIR'

€4'450'000 excl. vat | 23.75m | 2024

KEY POINTS

- A pocket explorer cruiser featuring an open aft platform
- Hull-integrated crane, hydraulic swim platform, and a hi-lo passerelle
- Main and lower decks designed exclusively for living spaces
- Coupe-style flybridge with electric side windows and an opening roof
- Powered by Volvo Penta IPS engines and equipped with CMC electric stabilizers



SPECIFICATIONS

| | |
|-----------------------------|------------------------------|
| Builder: | Sanlorenzo |
| Model: | SX76 |
| Year: | 2024 |
| Hull/Superstructure: | GRP / GRP |
| Deck material: | Teak |
| Exterior Designer: | Studio Zuccon International |
| Interior Designer: | Piero Lissoni |
| Flag: | Bulgaria |
| Length overall: | 23.75 m |
| Beam: | 6.6 m |
| Draft: | 1.6 m |
| Displacement: | 67 T |
| Guests: | 8 |
| Staterooms: | 4 |
| Crew: | 2 |
| Engines: | 2 x Volvo Penta IPS D13 1200 |
| Total Power: | 1800 HP |
| Engine Hours: | 215 hrs |
| Generators: | 2 x Kohler 28 kW |
| Generator Hours: | 288 h |
| Stabilizer | CMC electric stabilizers |
| Cruising Speed: | 18 knots |
| Maximum Speed: | 22 knots |
| Range: | 615 nm @ 11kn |
| Fuel Consumption: | 220 l/h @2100 rpm |
| Fuel: | 4,350 l |
| Fresh water: | 1,400 l |
| Black Water: | 400 l |























breezeYachting.swiss











breezeYachting swiss





EXTRAS

EXTRA EQUIPMENT

- Raymarine diamond navigation package
- Audio-video gold package
- Wine cooler for 12 bottles
- Sliding mirror door for the galley
- Strataglass cover for the flybridge
- Air conditioning on flybridge
- Hardtop with powered louver roof system
- Sun awning for the stern area of the flybridge behind the hardtop
- Sun awning for bow area
- Swimming platform lifting system
- Electric hi-lo folding table on flybridge

MECHANICAL EQUIPMENT

- Main Engines: 2 x Volvo Penta IPS D13 1200
- Engine Hours (Port): 215h
- Engine Hours (Stbd): 215h
- Generators: 2 x Kohler 28 kW
- Generator Hours (Port): 288
- Generator Hours (Stbd): 281
- Steering: IPS Drive
- Water Maker: Idromar 150 l/h
- Fuel Filters: Volvo Penta
- Air Conditioning: Dometic 95500 btu/h
- Bow Thruster: Sleipner electric
- Fire Pump: Centralized Fire Fighting FM200
- Bilge Pump: E/pump 24V, maximum capacity 150 l/min 24Vdc automatic bilge E/pumps
- Trim Tabs: Interceptors
- Stabilizers: CMC electric (at anchor and under navigation)



EXTRAS

ELECTRICAL SYSTEMS

- Shore Power: 2 x 230 V 63A shore power connection, single phase
- Electricity Output: 230 V AC single phase, 50 Hz for main power circuits
- 24 V DC for small power circuits, visual signals, emergency lighting electronics, communication systems and main engine start up
- 12 V DC for main generator start up and VHF
- Inverter: N°1 inverter 24V/230V, 1500W is provided for the galley refrigerator/freezer
- Service Batteries: A 700 Ah/24 V DC gel accumulator bank
- Main Engine Starting Batteries: 3 gel/AGM batteries with a capacity of 180 Ah @ 24 V DC
- Generator Starting Batteries: 1 of gel/AGM batteries, starting type, with a capacity of 180Ah @ 12V DC
- Bow thruster Batteries: 2 gel/AGM batteries 24V DC

NAVIGATION AND COMMUNICATION

- VHF
- AIS
- Autopilot: Raymarine
- GPS: Raymarine
- Gyro Compass: Raymarine
- Magnetic Compass: Raymarine
- Radar: Raymarine
- Depth Sounder: Raymarine
- Chart Plotter: 3 x Raymarine XL16
- Wind Instruments: Raymarine i70S
- EPIRB
- Night Vision: FLIR
- SART
- Sat internet: Starlink

GALLEY & LAUNDRY

- Extractor Fan: Miele
- Dishwasher: Milele
- Refrigerator/freezer: Samsung
- Ice Maker: Vitfrigo
- Washing Machine: Miele
- Dryer: Miele



EXTRAS

AUDIO/VIDEO EQUIPMENT

- ArtSound FL101 and FL301 in-ceiling speakers in cabins
- Focal Cub Evo compact subwoofer in the master cabin
- Denon RCD-N11 wireless music system
- JL audio M3-650X -S-GW waterproof speakers in the dining, aft, beach platform, flybridge areas
- Fusion MS-RA210 marine entertainment system
- Fusion MS-RA770 marine stereo on the flybridge and bow
- Samsung 50" Led TV UHD Smart in the main salon
- Samsung 43" Led TV UHD Smart in the master cabin
- Samsung 43" QLed FHD Smart in the VIP cabin
- 2 x LG 24" HD Ready Led TV Smart in twin cabins
- KVH TV6 TV-Sat antenna
- KVH TV6 empty radome

DECK EQUIPMENT

- Anchor Windlass: 1 x electric reversible anchor windlass 2300W, 24V
- Aft Warping Capstans: 2 x electrical capstans 1700W, 24V on stern and one capstan 2000W, 24V in the bow area
- Anchor Chain: 100 meters
- Boat Crane & Davits: Crane integrated in the hull 700kg max capacity
- Passerelle: Hi-lo passerelle with retractable steps
- Swimming Platform: Sliding hydraulic swim platform at the aft

SAFETY & FIRE PROTECTION

- Cameras: 1 x engineroom; 1 x stern
- Life Jackets: 16
- Life Rafts: 2
- Flares: 8
- Medical Equipment: 1 first aid kit
- Smoke Sensors
- Fire Control System
- Fire Extinguishers: 8
- Fire Alarms



LAYOUTS

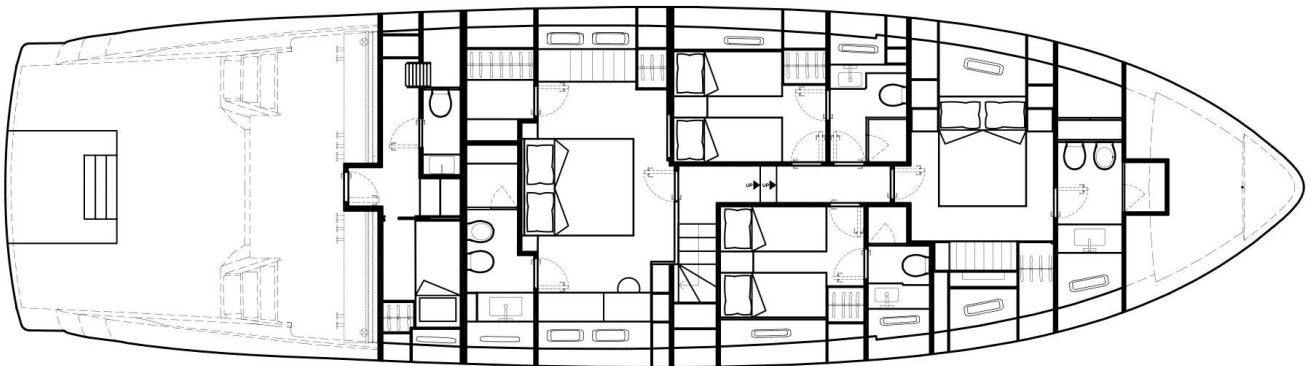
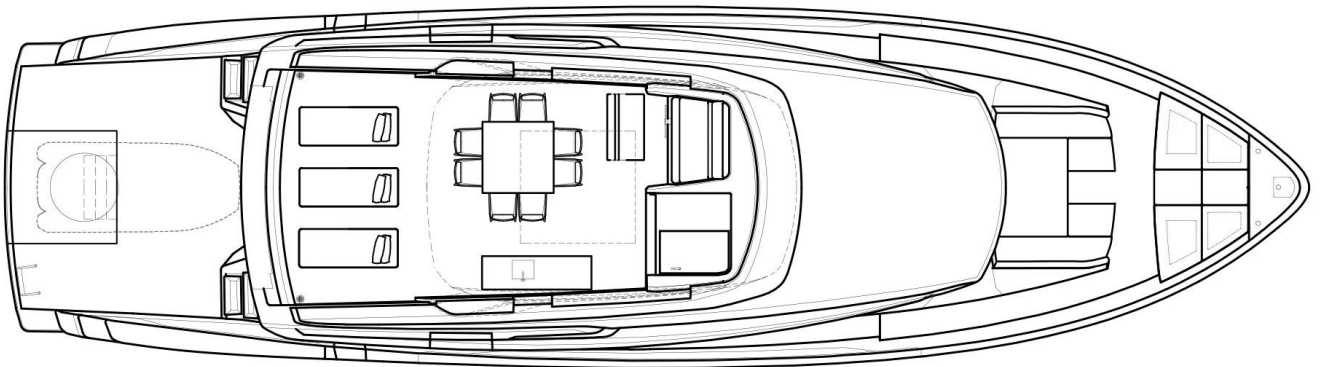
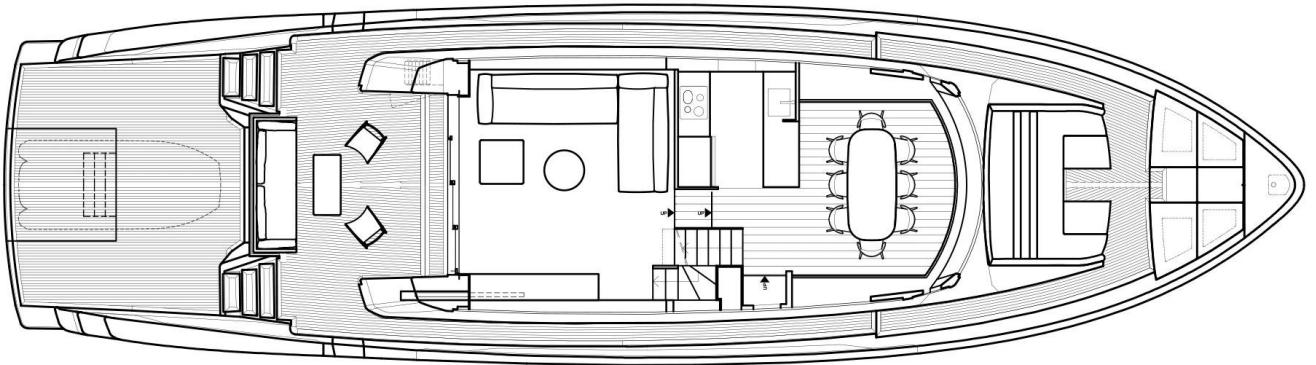



For video walkthrough, [CLICK HERE](#)



For more information, [CLICK HERE](#)

breezeYachting swiss





EMMA KARANOVA

Yacht Advisor

 WHATSAPP ME

m. +41 79 702 4000

emma@breezeyachting.swiss

breezeYachting.swiss

WE SPEAK YACHTING. LET'S TALK.

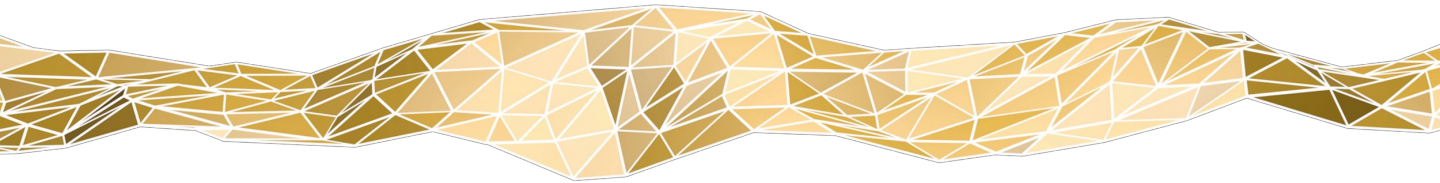

Switzerland ● Malta ● Spain ● Monaco

www.breezeyachting.swiss

DISCLAIMER

The company offers the details of this vessel in good faith but cannot guarantee or warrant the accuracy of this information nor warrant the condition of the vessel. A buyer should instruct his agents, or his surveyors, to investigate such details as the buyer desires validated.

This vessel is offered subject to prior sale, price change or withdrawal without notice.