

breezeYachting .swiss



# Sunreef 60A Galley-up 'FEEL THE BLUE'

EUR 2'850'000 VAT not paid | 18.4m | 2018/2022

# KEY POINTS

- 5 Cabins Galley up Layout can sleep 10 guests
- Charter machine, 9-12 weeks feasible even with 6 Owner weeks!
- All 2024 services done, many smart upgrades, ready for new owner
- The open Space feeling on board, well balanced design between open and closed spaces
- Take over a winning charter setup making more money than you spend on maintenance, with top crew, top location and top yacht!





breezeYachting.swiss















# SPECIFICATIONS

<b>Builder:</b>	Sunreef Yachts
<b>Model:</b>	60A Galley-up
<b>Model Year:</b>	2018
<b>Refit Year:</b>	2022
<b>Flag:</b>	Madeira
<b>Hull/Superstructure:</b>	GRP
<b>Class:</b>	CE A (boat) and CE for engines / Yearly RINA
<b>Exterior Design:</b>	Sunreef Yachts
<b>Length overall:</b>	18.40 m
<b>Beam:</b>	10.20 m
<b>Draft:</b>	2.10 m
<b>Cabins:</b>	5
<b>Guests:</b>	10
<b>Heads:</b>	5
<b>Crew:</b>	3
<b>Engines:</b>	Twin Volvo Penta D3 engines
<b>Engine power:</b>	220 HP
<b>Fuel Type:</b>	Diesel
<b>Generators:</b>	Acuva Generator 19KVA, 50Hz, 230V
<b>Cruising Speed:</b>	7 kn
<b>Range:</b>	500 miles Incl. Reserve = 3 days non stop @ 7 kn
<b>Fuel Tank:</b>	1700 l
<b>Water Tank:</b>	800 l
<b>Black Water:</b>	170 l













# REFIT HISTORY

- New 100 m stainless steel anchor chain (Cromox-Duplex stainless steel CXA13 mm, DIN 766A) instead of the old, galvanized 80 m chain
  - New anchor winch and new anchor control system
  - Replacement of the cracked front nets in black instead of white (original Sunreef nets)
  - Installation of 8 new high-performance batteries so that the generator does not have to start at night
  - 2nd Rainman AC240 watermaker with 140 liters per hour as a fallback line in case the large watermaker should fail
  - Fly: take off jacuzzi and instead install height-adjustable 190 x 110 cm teak table with 2 benches and sunshade
  - Installation of ACUVA UV water filter system for drinking water generation (Arrow5)
  - Solid teak floor in the saloon/kitchen
  - Additional Liebherr refrigerator with different cooling zones
  - New washing machine
  - New ice cube machine
  - 2 new exhaust systems for Volvo Penta engines
  - Installation of new rudder calibration system
  - Purchase of Seabob F5s in black/white colour scheme
- 



# SAILS AND RIGGING

- Carbon performance Mast and boom (upgrade )
  - Lazy Jack and lazy Jack bag
  - Fully battened main sail made of Dacron, 2 reefs
  - Genoa double pleated made of Dacron and electric winch
  - Electric furling system for Genoa and Gennaker
  - Gennaker made out of polyester. Complete gear for Gennaker / Code 0, incl. electric furler (upgrade)
  - Asymmetric SPI (Upgrade)
  - Parasailor (upgrade) 260m<sup>2</sup>
- 

# ENGINE ROOM

- Steering: 5 Spoke steering wheel (800mm diameter )
  - Watermakers: 1 x Searecovery 230L/h & 1x Rainman 140L/h
  - Fuel Filters Volvo Penta
  - Air Conditioning: 62000 BTU/h
  - Bow Thruster: Electric on Stb side hull
  - Fire/Bilge Pump: 2 manual/4 electrical bilge pumps
  - Rudder Angle Indicator
- 





# SAILS AND RIGGING

- Carbon performance Mast and boom (upgrade )
  - Lazy Jack and lazy Jack bag
  - Fully battened main sail made of Dacron, 2 reefs
  - Genoa double pleated made of Dacron and electric winch
  - Electric furling system for Genoa and Gennaker
  - Gennaker made out of polyester. Complete gear for Gennaker / Code 0, incl. electric furler (upgrade)
  - Asymmetric SPI (Upgrade)
  - Parasailor (upgrade) 260m<sup>2</sup>
- 

# ENGINE ROOM

- Steering: 5 Spoke steering wheel (800mm diameter )
  - Watermakers: 1 x Searecovery 230L/h & 1x Rainman 140L/h
  - Fuel Filters Volvo Penta
  - Air Conditioning: 62000 BTU/h
  - Bow Thruster: Electric on Stb side hull
  - Fire/Bilge Pump: 2 manual/4 electrical bilge pumps
  - Rudder Angle Indicator
- 



# ELECTRICAL SYSTEMS

- Shore Power: 2x shore power inlet 63A
  - Electricity Output: 3x socket 230V in cabins, 4 in saloon, 4 in dining area and 4 in galley, 2xUSB socket in each cabin and 2x in saloon
  - Converter: 24V to 230V for silent operation
  - Batteries: DC-25.6V: main switchboard, 22,4 kWh Lithium battery bank (25.6 Volts), starting batteries, DC distribution, wiring
- 

# COMMUNICATION & BRIDGE

- VHF DSC Controller X 2: BNG
  - AIS: AIS700NAVTEX
  - Autopilot: BNG evolution autopilot
  - GPS: BNG Chartplotter
  - Magnetic Compass: Compass- 135mm
  - Radar: BNG Radar 4k
  - Depth Sounder: BNG
  - Chart Plotter: BNG
  - Wind Instruments: BNG
  - Searchlight
  - EPIRB
- 



# GALLEY

- Cooking Equipment: New gas stove, electric oven
  - Microwave: Yes – stainless steel
  - Extractor Fan
  - Dishwasher
  - Refrigerator: New Liebherr Fridge in Galley, 1 aft cockpit fridge
  - Freezer with fridge
  - Ice Maker
  - Washing Machine
- 

# DECK EQUIPMENT

- Anchor Windlass: Regal
  - Anchors: Ultra
  - Anchor Chains: New stainless anchor chain 100 m
  - Passerelle: Hydraulic Gangway
  - Swimming Platform: 850kg lifting capacity hydraulic
- 



# TENDERS & TOYS

- Tenders: Tender Williams SportJet 395 – 90hp (complete overhaul in 2023)
  - Dive Gear: Seabob F5 S, 6-gears, max. Speed 20 km/h, Akku ø 60 min, incl. Quick charger
  - Recreation: 2 Jobe wakeboards; Jobe waterski in blue
  - Exercise Equipment: 2 Stand up Paddels
  - Water Toys: Jobe Towable Binar 250 x 200 Lunar 3 and Jobe Scout Towable 215 x 180 Scout 3
- 

# SAFETY & FIRE PROTECTION

- Security Equipment
  - Cameras: 2 Stern Cameras
  - Life Jackets
  - Life Rafts: 2 x 8 Pax
  - Flares
  - Medical Equipment
  - Emergency VHF
  - Smoke Sensors
  - Fire Control System
  - Fire Extinguishers
  - Fire Alarms
- 



# LAYOUTS

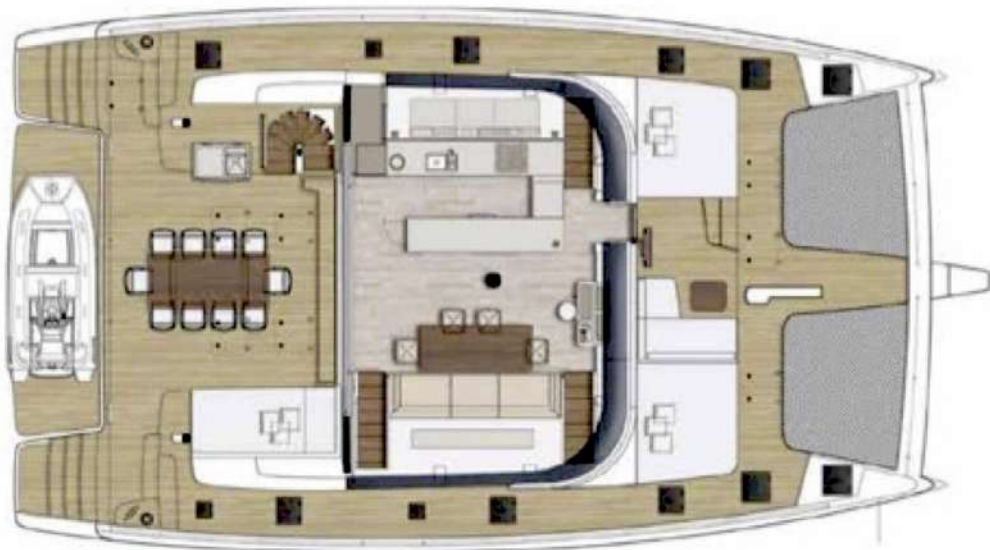
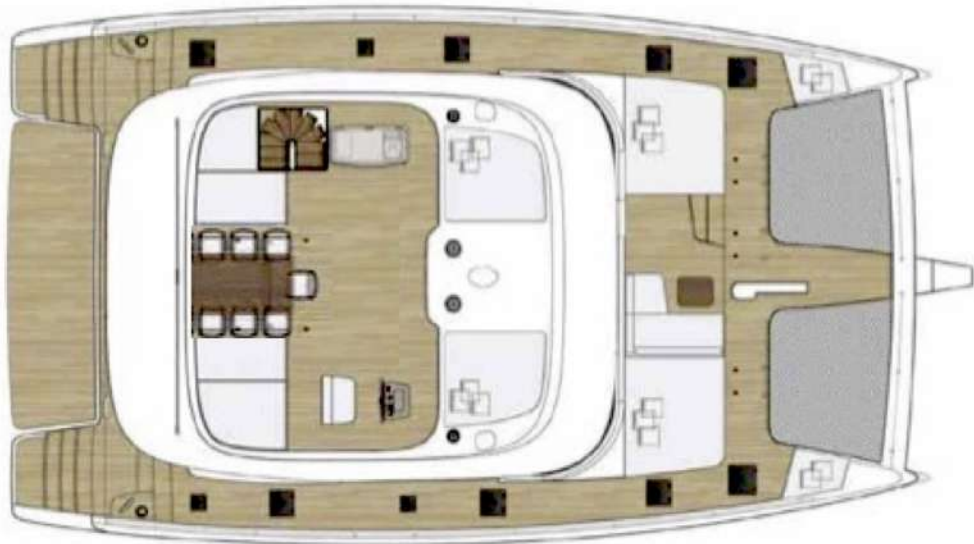



[For more information, CLICK HERE](#)

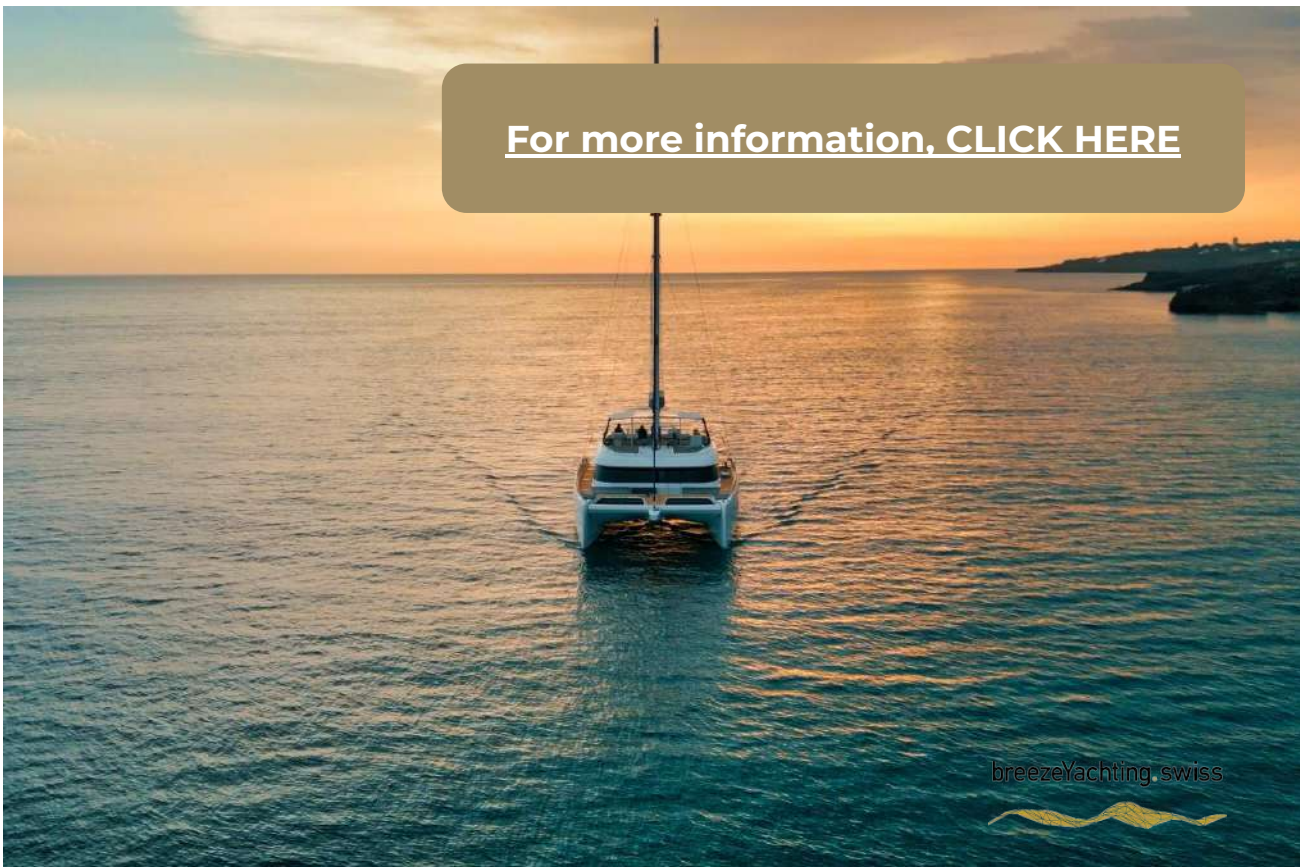

breezeYachting.swiss





**CORNELIUS KISTLER**

Founder & CEO

 WHATSAPP ME

m. +41 79 702 7000

[ck@breezeyachting.swiss](mailto:ck@breezeyachting.swiss)

# breezeYachting.swiss

WE SPEAK YACHTING. LET'S TALK.

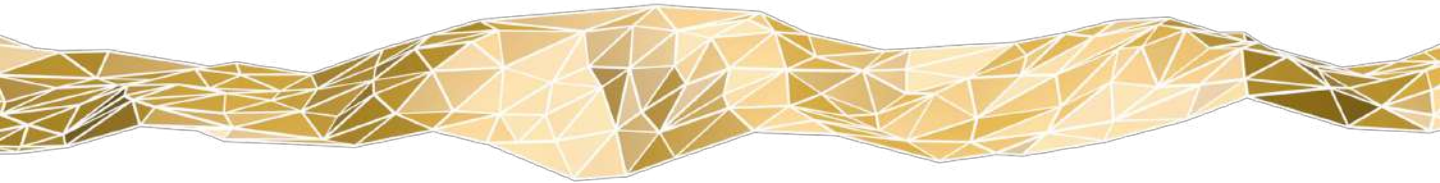

Switzerland ● Malta ● Spain ● Monaco

[www.breezeyachting.swiss](http://www.breezeyachting.swiss)

#### DISCLAIMER

The company offers the details of this vessel in good faith but cannot guarantee or warrant the accuracy of this information nor warrant the condition of the vessel. A buyer should instruct his agents, or his surveyors, to investigate such details as the buyer desires validated.

This vessel is offered subject to prior sale, price change or withdrawal without notice.